

TYPICAL SPECIFICATIONS:

MIN WIDTH - 21"
MAX WIDTH - 48"

MIN HEIGHT - 30"
MAX HEIGHT - 48"

MIN DEPTH - 9"
MAX DEPTH - 30"

FINISHED END TYP.

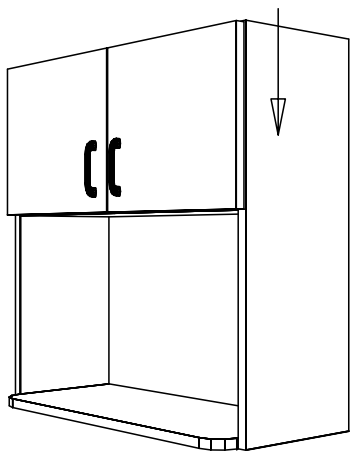

*LIGHT RAILS SHIP LOOSE IN 8' LENGTHS. TRIMMED TO LENGTH AND INSTALLED IN FIELD.

HANGING RAIL UNFINISHED END TYP.

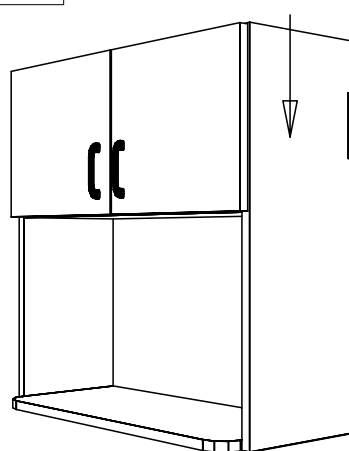

LIGHT RAIL UNFINISHED END TYP.

